



Spring Grove Cemetery

Cemetery Sexton,

James Hjort

785 E. Washington

Medina, Ohio 44256

330-722-9056

springgrovecemetery@medinaoh.org



*To search for your loved
one, follow the QR Code.*

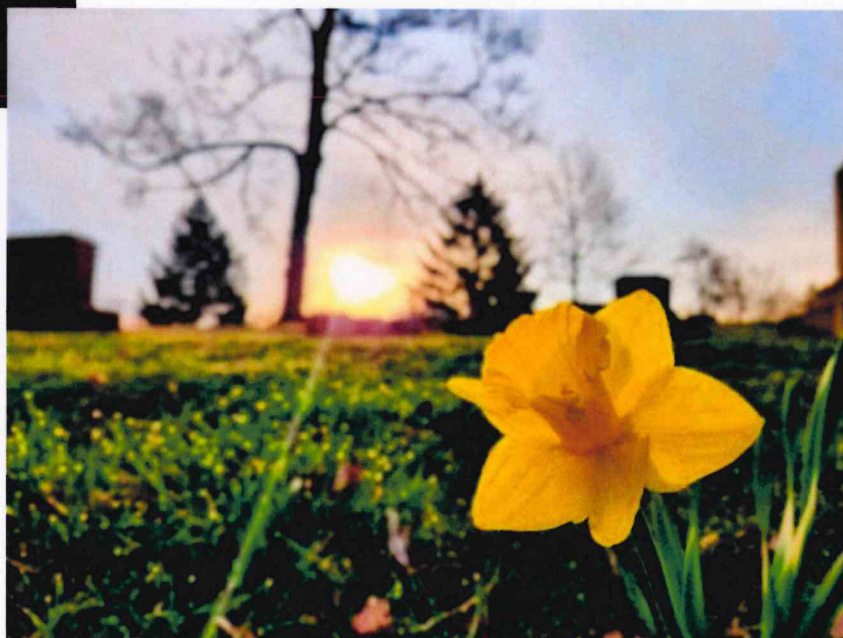

943.11 SCHEDULE OF CHARGES AND FEES*(ORD 102-24 passed May 28, 2024 effective 30 days)*

LOT FEES PER GRAVE:			
Lot Type	No. of Lots	Resident	Non-Resident
A	per grave	\$650.00	\$750.00
B	per grave	\$850.00	\$950.00
C	per grave	\$750.00	\$850.00
Cremains Section	per grave	\$300.00	\$350.00
Baby Section	per grave	\$300.00	\$350.00
Private Mausoleum: Single \$3,000.00 centered over 2 graves spaces			
Private Mausoleum: Double \$4,500.00 centered over 3 graves spaces			
DESCRIPTION OF SALEABLE LOTS:			
Class "A" lots, single or multiple graves: All Sections except 14, 17, 18 and 19			
Class "B" lots, single graves: Section 14 and 17			
Class "C" lots, single graves: Section 18 and 19			
Cremains Section: Section specifically located in Section 8			
Baby Section: Single grave only, available in sequential order			
Private Mausoleum: Section 13 only and at the discretion of the Cemetery. A complete set of construction plans must be submitted for review and approval by the Cemetery.			
INTERMENT FEES:			
Interment of Residents or Non-residents	Before 2:00 p.m. Weekdays	After 2:00 p.m. Weekdays and until 12:00 Noon Saturday	After 12:00 Noon Saturday or Sunday (Court Ordered) and approved holidays Ord. 184-17, passed 12-11-2017
Adult	\$600.00	\$900.00	\$1,200.00
Cremains	\$350.00	\$450.00	\$700.00
Baby Section	\$350.00	\$450.00	\$700.00
Crypt	\$600.00	\$900.00	\$1,200.00
DISINTERMENT AND REINTERMENT FEES:			
	Adult Vault	Adult Cremains	Infant
Disinterment	\$2,000.00	\$600.00	\$500.00
FOUNDATION FEES:			
A fee of \$0.75 shall be charged per square inch of surface material of concrete. All footers shall have a two-inch (2") border around the entire base. Flush markers shall not have a mandatory border.			
COLUMBARIUM/NICHE WALL: (cremains interments only)			
CLBM-1 and CLBM-2: SOLD OUT			
CLBM- One (1) Niche – Top Row - \$3,250.00			
CLBM- One (1) Niche – Middle Row - \$2,750.00			
CLBM- One (1) Niche – Bottom Row - \$2,250.00			
Interment (max. two urns (2) per niche)			
Engraving - Actual cost			
ADDITIONAL SERVICES:			
1. Upon request, the Director of Public Service shall give written estimates of work to be done by cemetery employees on the cemetery grounds not covered in the foregoing schedules.			
2. There shall be a \$100.00 charge for chapel use for a funeral or memorial service.			
3. There shall be a \$100.00 Transfer of Lot Fee for all lot transfers.			
4. There shall be a \$250.00 administrative fee for all columbarium niches sold back to the City.			
5. There shall be a \$600.00 charge for replacement niche covers, as applicable.			

NOTE: For credit / debit card transactions, there will be a fee of 2.95% per transaction effective October 1, 2024 Notice of not less than forty-eight (48) hours shall be given for opening a grave. Per City Ord. 943.04-J

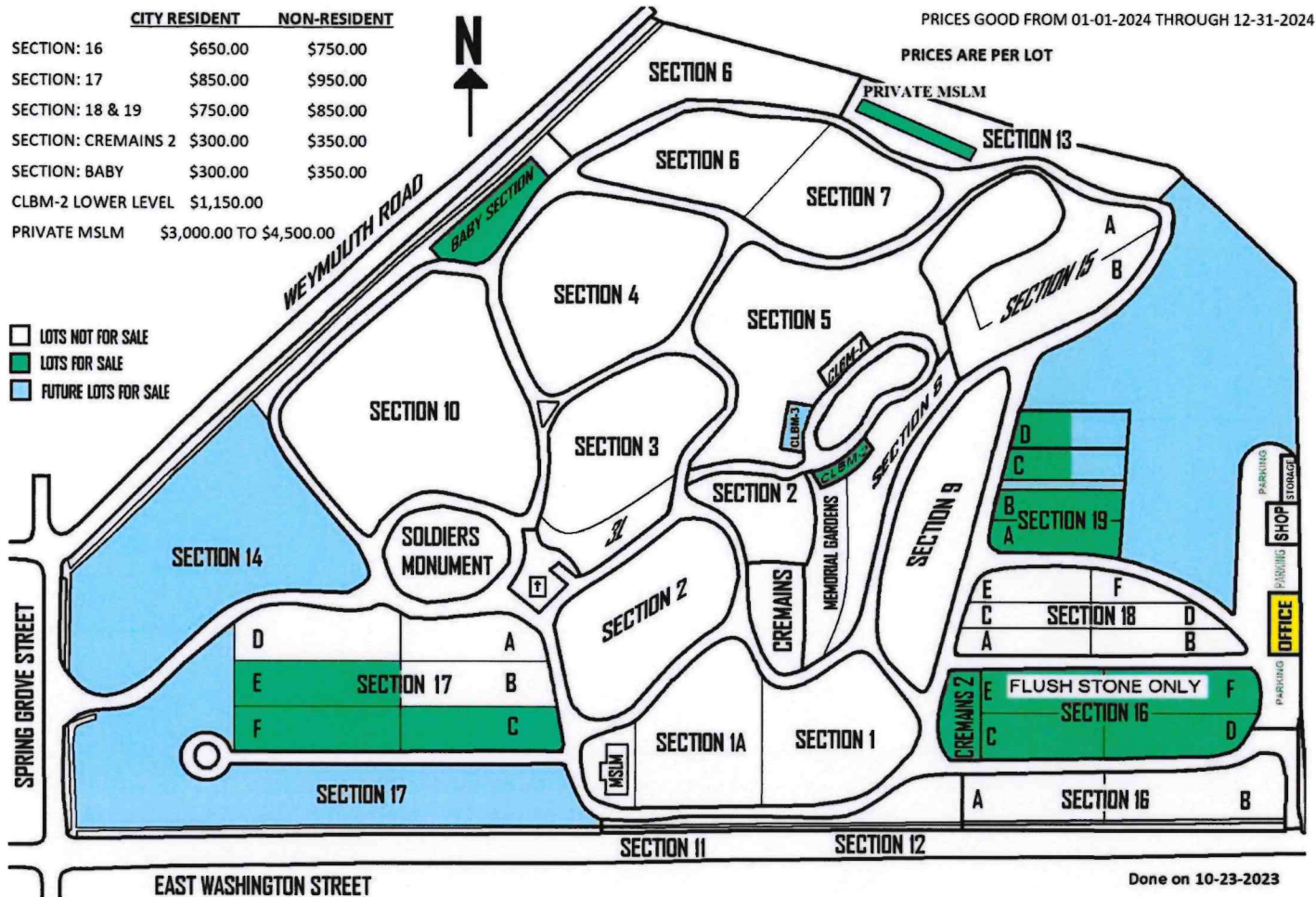

MONUMENT COMPANIES

These are the companies that are normally used however the City does not endorse / nor limit any specific company.

NOTE: Please consult Rules and Regulations Section 943.06 (1) Ordinance No. 45-20 for monument specifications..

Contact Spring Grove Cemetery for a Footer Application.

MONUMENT WORKS

Address: 155 KOONS AVE.,
MEDINA, OH 44256

Phone: (330) 421-8924

FAX: N/A

KOTECKI FAMILY MEMORIALS

Address: 127 W Smith Rd,
Medina, OH 44256

Phone: (330) 725-8848

FAX: (330) 722-5862

THOMPSON-CHAPMAN MEMORIALS

Address: 327 S Market St,
Wooster, OH 44691

Phone: (330) 264-8703

FAX: (330) 601-1016

MIDWEST EVERLASTING MEMORIALS

ADDRESS: 1244 HIGH STREET,
WADSWORTH, OH 44281

PHONE: (330) 334-1988

FAX: (330) 334-1989

WWW.MIDWESTEVERLASTINGMEMORIALS.COM

MILANO MONUMENTS

Address: 14600 Brookpark Rd,
Cleveland, OH 44135

Phone: (216) 362-1199

FAX: (216) 362-8230

PERTEE MONUMENTS

Address: 4105 Cleveland Rd,
Wooster, OH 44691

Phone: (330) 345-8811

FAX: (330) 345-3404

JOHN CARABELLI

ADDRESS: 14110 Brook Park Rd.

Brook Park, OH 44121

PHONE: 216-267-8585

Seasonal Clean Off: The Annual spring clean off is **March 16, 17 and 18**. The Annual fall clean off will be **October 16, 17 and 18**.

Footer Pours: For upright monuments, footers are poured three times annually. Typically July / August; August / September and September / October. *All subject to change, based on weather.*

943.06 MARKERS, MONUMENTS, FOUNDATIONS AND NICHE COVERINGS

(ORD 141-23 approved September 12, 2023 eff October 12, 2023)

- (A) All burials and cremains interred in Spring Grove Cemetery may be identified with a monument or marker.
- (B) Monuments may be erected in all sections except Section 16, Rows A, B, F through L, Cremains Section and Baby Section.
- (C) A single monument or marker is permitted on each grave space at the head of the grave. All lots are permitted a foot marker except in the Cremains and Baby Sections.
- (D) No markers or monuments shall be erected or placed in the cemetery unless application, specifications, plans and location have been first submitted to and approved by the Director of Public Service.
- (E) To insure permanency all foundations shall be built by cemetery employees or contractors approved by the Director of Public Service at the expense of the grave owner with the exception of foundations for private mausoleums. Foundations for private mausoleums will be dug and poured by the monument company at the Owner's expense.
- (F) The Director of Public Service shall have the authority to inspect the setting of any monument or marker, and if improperly set, order the resetting of same.
- (G) After a monument or marker has been placed in the cemetery, it shall not be removed without written permission of the Director of Public Service.
- (H) All inscriptions, whether raised or engraved, shall be at least one eighth inch (") deep
- (I) All engraving on niche coverings must conform with specifications on file in the office of the Director of Public Service.
- (J) Deceased who served in the armed forces, and who are entitled to receive a bronze or granite marker from the United States Government, shall be allowed to have that marker at the foot of their grave in all sections, except the Cremains Section due to limitations of size. Military markers to be attached to a monument must be professionally installed
- (K) Bronze military markers are permitted to be placed on the back of upright monuments or set in concrete as a flush marker.
- (L) The following dimensions shall not be exceeded for monument bases and **tablets in all Sections**. The minimum monument width of a base shall not be less than six (6) inches, or wider than fourteen (14) inches. The maximum height of the base shall not exceed (10) inches. The maximum tablet height shall not exceed (48) inches.

Number of Grave Spaces	Width of Grave Space	Length of Marker	Height of Tablet
One (1)	36 inches	32 inches	48 inches
One (1)	48 inches	34 inches	48 inches
Two (2)	48 inches	60 inches	48 inches
Two (2)	36 inches	48 inches	48 inches
Baby Section	24 inches	18 inches	N/A
Cremains Section	36 inches	24 inches by 12 inches wide	N/A

The dimensions for private mausoleums shall be as follows:

Single Private Mausoleum: Not to exceed 55 inches in width, 155 inches in length, and 58 inches in height

Double Private Mausoleum: Not to exceed 96 inches in width, 155 inches in length, and 58 inches in height

943.07 DECORATIONS, ORNAMENTS AND FLOWERS

- (A) All monuments are permitted a seasonal planting area extending no more than ten inches (10") from the foundation on the burial side of a monument. All decorations, ornaments and flowers must be installed within this area.
- (B) Only one (1) shepherd's hook or one (1) potted plant is permitted on a marker.
- (C) Seasonal items on lots will be removed by City employees on or after the following dates. Items not removed prior to these dates will be discarded:
 - Summer decorations shall be removed from lots on or before October 15th
 - Fall decorations shall be removed from lots on or before December 15th.
 - Winter decorations shall be removed from lots on or before March 15th.
- (D) Funeral designs, floral pieces, and wreaths shall be removed from graves when they become wilted or unsightly. Persons desiring to retain funeral designs or floral pieces must remove the same within forty-eight (48) hours after the interment or they will be discarded. In no case shall City employees attempt to locate designs, floral pieces or wreaths after their removal from a lot. (Ord. 25-05. Passed 2-14-05.)

SPRING GROVE CEMETERY

MEDINA, OHIO

APPLICATION FOR APPROVAL: MONUMENTS, MARKERS, AND FOUNDATION ORDER

Company: _____ Check No: _____
 Address: _____ Amount: _____
 Date: _____ Signed: _____

MONUMENT DESCRIPTION, DIMENSIONS AND LOCATION

Material: _____ Section: _____
 Color: _____ Lot: _____
 Shape: _____ Grave: _____
 Type: _____ Lot Owner's Signature: _____



UPRIGHT MONUMENT (INCLUDE DIMENSIONS) FLUSH OR FLAT MARKER (INCLUDE DIMENSIONS) HICKEY OR SLANT (INCLUDE DIMENSIONS)

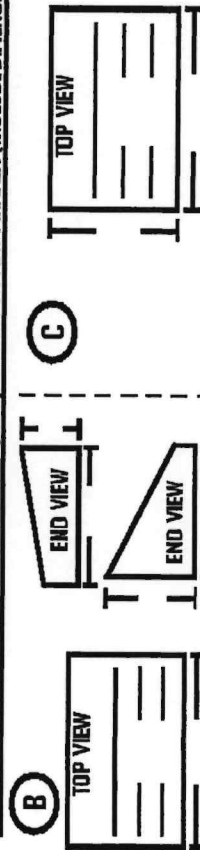

(L + 4) x (W + 4) x .75 = COST OF FOUNDATION FOR 2023

FOR CITY OF MEDINA USE:

Received on: _____ Approved: _____
 Notes: _____ By: _____
 Date: _____

11.75" X 11.8"

BLACK
 SAMUEL E.
 1945 2001

ALL LETTERING
 IS MODIFIED ROMAN

SURNAMES ARE 1.25" HIGH
 FIRST NAMES & INITIALS ARE
 1" HIGH

DATES ARE 0.75" HIGH

INSCRIPTION EXAMPLE
 SINGLE CREMAINS WITHOUT EMBLEM

STANDARD PANEL LAYOUT

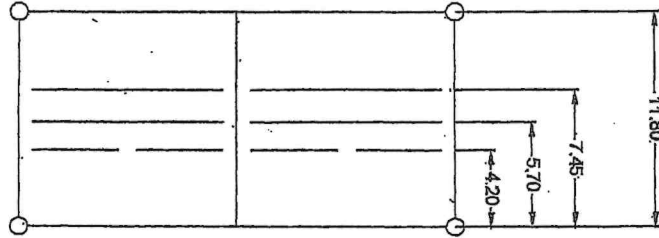

CITY OF MEDINA
 SPRING GROVE CEMETERY
 COLUMBARIUM PANEL INSCRIPTION

OWNERS APPROVAL: _____ DATE: _____
 COLUMBARIUM NUMBER: _____ NICHE NUMBER: _____
 SEXTON APPROVAL: _____ DATE: _____

CITY OF MEDINA SPRING GROVE CEMETERY
785 EAST WASHINGTON STREET
MEDINA, OHIO 44256

DATE:

TO WHOM IT MAY CONCERN:

I, _____, DESIGNATE THAT MY CEMETERY
IN SECTION _____ LOT NUMBER _____, LOCATED IN SPRING
GROVE CEMETERY, MEDINA, OHIO TO BE USED FOR THE BURIAL OF:

I STATE THAT I AM THE LEGAL OWNER OF THIS LOT, AND THIS IS MY REQUEST.
(PLEASE CHECK ONE)

☐ I HAVE ATTACHED A COPY OF THE DEED FOR SAID LOTS.

☐ I DO NOT HAVE A COPY OF THE DEED BUT CAN PROVE OWNERSHIP.

SIGNED: _____

DATE: _____

WITNESS: _____

943.03 LOTS

(a) The deed to a lot conveys burial rights only. The ownership of the land remains with the City of Medina.

(b) Lots are sold and intended for the family, relatives and descendants of the deeded lot owner, and other persons designated in writing to the Director of Public Service by lot owners during their lifetime.

(c) When a lot owner dies intestate or without having designated on file in the office of the Director of Public Service the name of the person to be interred in a lot, the heirs are recognized according to the laws of Ohio.

(d) Where there are two or more persons interested as owners of a lot, no dividing lines within the same shall be recognized. All owners shall have equal rights of interment.

(e) Refer to Section 943.11 for lot descriptions, types, sizes and pricing.
(Ord. 25-05. Passed 2-14-05.)